

Telephone Pillar

High-strength cold-rolled steel housing with outdoor powder coating provides excellent corrosion resistance. SUS304 or SUS316 stainless steel can also be used to meet higher weather resistance requirements.

Designed specifically for emergency telephone and circuit integration installations.



MAIN FEATURES

JR-TP-01 Telephone pillar designed for installation on public and private roads. Designed for high mechanical strength and combined with a very long service life when exposed to harsh weather conditions, including saline atmospheres.

Its simple design, without sharp edges, meets European recommendations and major safety regulations worldwide. The front part is designed to accommodate all J&R series telephones, for Emergency and Service.

Cable entry is provided in bottom of the terminal, and prepared for the containment of auxiliary circuits.

Applications: campuses, parking lots, airports, commercial centers, hospitals, industrial parks, walkpath, amusement parks / recreational Facilities, highways/tunnels and remote outdoor areas such as forest parks.

- Suitable all J&R telephones
- Traffic yellow color for high visibility (custom colors available upon request)
- Warranty: 12 months
- Floor-mounted, stable structure
- Necessary mounting hardware



(for reference only)

APPLICATION SCENARIO



Highway



Railway



Scenic spots



Seaside



Smart city



School



Parking



Industry zone

DIMENSIONS

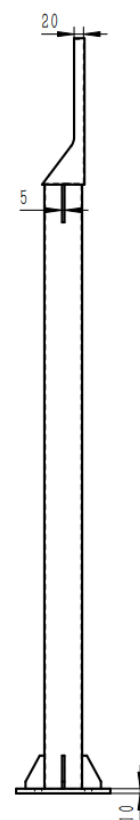
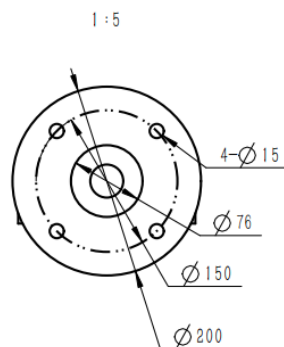
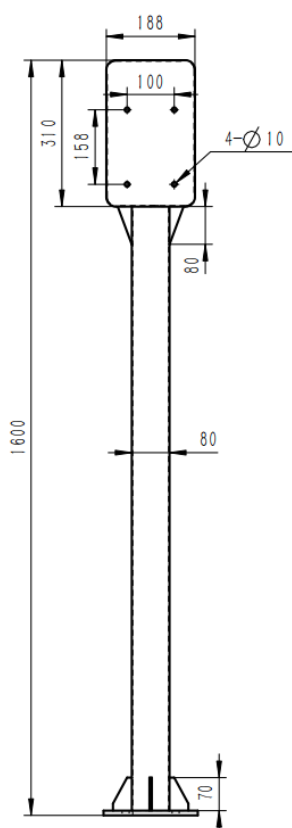

Package	
Unit size	1600*188*200 (mm)
Shipping dimensions	1650*440*360 (mm)
Packaging materials	Foam padding, wooden case
Weight	43 kg (for 2 units)

